

positioning of the oil hole is not critical. When properly installed the cam bearing oil hole should be fully exposed to the groove. Careful installation of the cam bearing will assure that this is accomplished.

OIL FILTER ADAPTER

Two square cut seals are used to seal the oil passages between the oil filter adapter and the engine block. **Figure 6D1-34**. Care must be used when installing the seals to be sure they are located against the adapter seats. These seals should be replaced whenever the adapter is removed from the block.

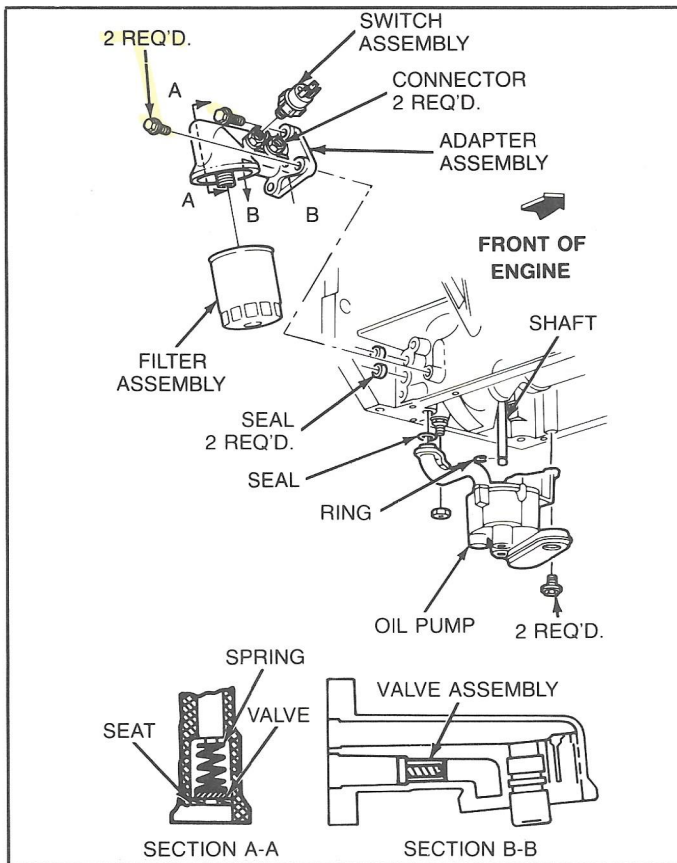

Figure 6D1-34 Oil Filter Pump and Adapter

ENGINE OIL PAN (DW & DM SERIES)

a. Removal

1. Disconnect negative battery cable.
2. Raise car on hoist.
3. Drain oil.
4. Remove engine oil filter.
5. Remove flywheel inspection cover and support struts.
6. Disconnect exhaust "Y" pipe at exhaust manifolds. Remove one bolt at catalytic converter bracket.
7. Remove oil pan screws, lower exhaust pipe, and remove oil pan. If pan is difficult to remove "bump" pan with a plastic hammer. Do not hammer against a flat part of pan. Hammer only at edges to prevent damage to the pan.

b. Installation

1. Thoroughly clean surfaces of oil pan and engine block.
2. Seal oil pan to engine block with RTV such as 1052751 or equivalent using RTV installation techniques described previously. Be sure adequate RTV is applied at the crankcase front cover - oil pan joint.
3. Reinstall oil pan screws and nuts and torque to 15 N·m (15 ft. lbs.), **Figure 6D1-35**.
4. Reposition exhaust "Y" pipe to manifolds and secure pipes to manifolds.
5. Install screw securing converter at converter bracket.
6. Install flywheel inspection cover and tighten screws. Install support struts and torque fasteners to 45 N·m (35 ft. lbs.).
7. Install oil filter.
8. Lower car and refill crankcase with engine oil.
9. Connect negative battery cable.
10. Start engine and check for leaks. Recheck oil level.

ENGINE OIL PAN (E/K SERIES)

a. Removal

1. Raise car on hoist.
2. Drain oil.
3. Remove engine oil filter.
4. Remove flywheel inspection cover.
5. Remove final drive as described in Section 4C.
6. Disconnect exhaust "Y" pipe from both exhaust manifolds.
7. Remove front suspension stone shield.
8. Remove two nuts securing engine mounts to frame crossmember.
9. It is necessary to raise the engine 1" - 2". Do not lift on the engine oil pan or the crankshaft. Use a 2x4 block of wood against the cylinder head ledge of the crankcase or against the cylinder head. Prop the engine up in this position.
10. Remove oil pan screws, lower exhaust pipe and remove oil pan.
11. Clean surfaces of oil pan and block.

b. Installation

1. Inspect sealing flange of oil pan to ensure that flange is not distorted. If damage exists flange should be reformed using a wood block and plastic hammer. Apply a continuous bead 3-4 mm in diameter of RTV sealer such as 1052751 or equivalent to the sealing flange of the pan. Apply bead on the inside of the oil pan screw holes. Totally encircle all of the oil pan screw holes with RTV. Refer to RTV techniques described previously for proper application and curing procedures. Be sure adequate sealer is applied to the crankcase front cover to oil pan.
2. Apply a continuous bead 3-4 mm in diameter of RTV sealer such as 1052751 or equivalent to the sealing flange of the pan. Apply bead on the inside of the oil pan screw holes. Totally encircle all of the oil pan screw holes with RTV. Refer to

61
6

#1622985
SEALS, SQUARE
cut.

6M00-005
031789

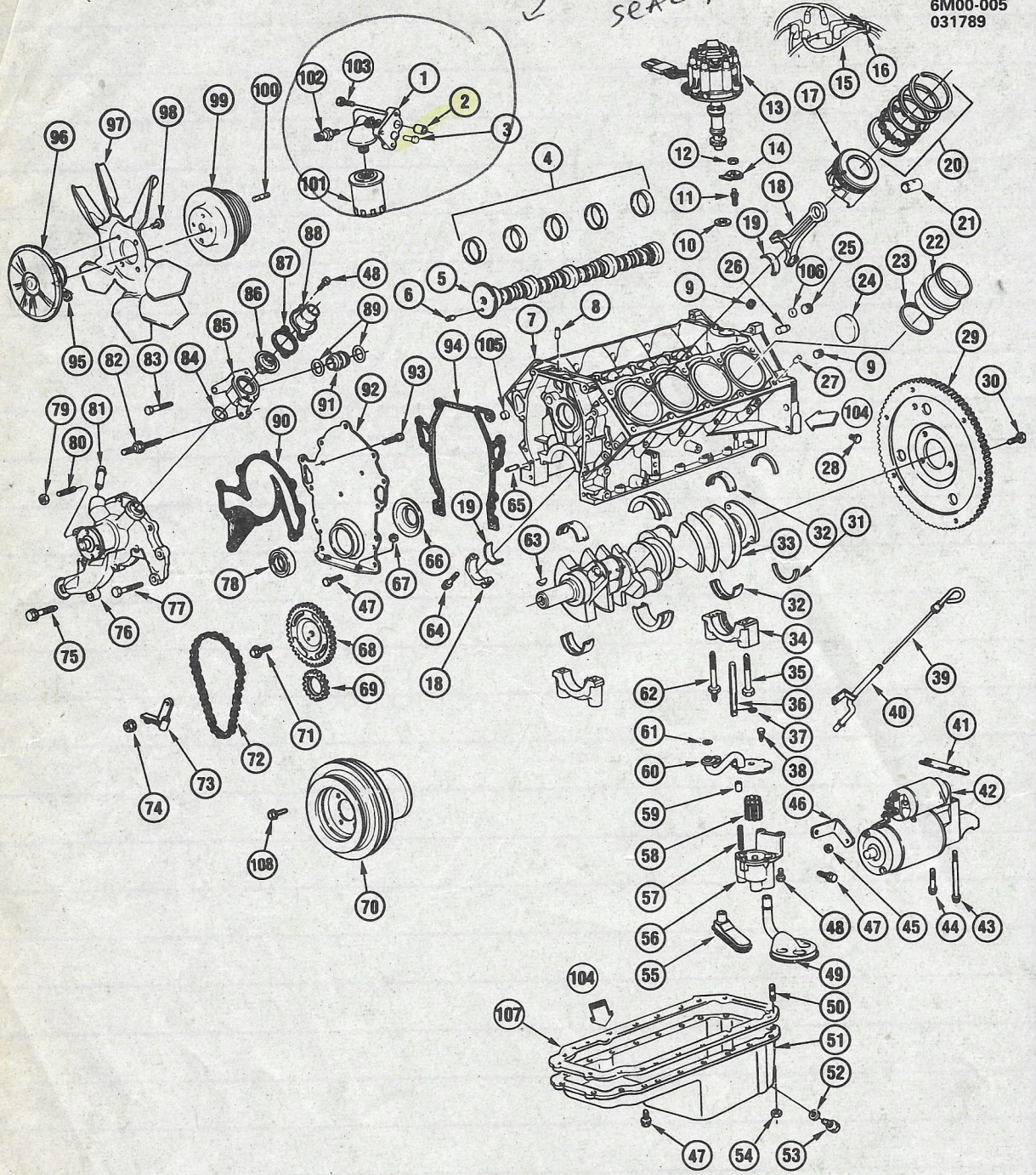

6M00-005

1982-1983 C ENGINE ASM-4.1L V8 PART 1 (LT8/4.1-8)

1.	1.840	ADAPTER, OIL FLTR	3517494
	1.540	FITTING, OIL FLTR ADAP (2)(*3)	10070158
2.	1.840	GASKET, OIL FLTR ADAP	1622985
3.	1.837	VALVE, OIL FLTR BY PASS	25011265
4.	N.S.	BEARING, CM/SHF (PART OF 7)	
5.	0.519	CAMSHAFT, ENG (INCL 6)	1628822
6.	N.S.	PIN, CM/SHF (M8X14)(PART OF 5)	
7.	N.S.	ENGINE, PARTIAL(*1)	
8.	3.275	PIN, MANIF LOC (M12X24)(PART OF 7)	1619395
9.	8.971	PLUG, SQ SOC (3/8-18)(PART OF 7)(1982-83)(*3)	
	0.034	PLUG, CR/CASE OIL HOLE (3/8-18 HEX REC SOC)(1984-85)(*3)	1628881
10.	2.379	WASHER, DISTR PIN (12.36 ID 32.00 OD)	1619044
11.	2.363	STUD, DISTR CLA (M10X1.5X20/M10X1.5X20 10.9 POR)(*3)	22535073
	2.363	STUD, DISTR CLA (M10X1.5X20/M10X1.5X20 10.9 POR)(*3)	14101259
12.	8.915	NUT-HEX 10X1.5X9 PC 10 (AR)	11500424
13.	N.S.	DISTRIBUTOR, IGN(*4)	
14.	2.363	CLAMP, DISTR RET	1623729
15.	2.240	WIRE, SPLG(*1,2)	12036928
16.	2.251	RETAINER, IGN WIRE (4 WIRE)	1625931
17.	0.629	PISTON KIT, W/PIN W/LNR AND RINGS (INCL 20,21,22,23)	1641773
18.	0.603	ROD, CONN	1645196
19.	0.616	BEARING KIT, CONN ROD	18009085
20.	0.643	RING KIT, PSTN (PART OF 17)	1623817
21.	N.S.	PIN, PSTN (PART OF 17)	
22.	N.S.	LINER, PSTN SLEV (PART OF 17)	
23.	0.629	SEAL, CYL LNR O RING (PART OF 17)	1621807
24.	8.970	PLUG, CUP EXPANSION 2.125 DI STEEL PL(AR)	9421761
25.	N.S.	PLUG, HEX SOC (1/2-14)(1982-83)(*3)	
	0.034	PLUG, CR/CASE OIL HOLE (M22X1.5)(1984-85)(*3)	1636022
26.	8.939	PIN, DOWEL STRAIGHT 5/8 DIA 1 3/16 LG(AR)	12338119
27.	0.293	PIN, CYL HD SL (M15.5X17)	1634935
28.	8.971	PLUG, 1/8-27 AUTO HH PIPE-PL(AR)	444613
29.	0.666	FLYWHEEL, CR/SHF	1623936
30.	0.679	SCREW, FLEX PLT TO CR/SHF (M10X1.5X16)	1623831
31.	0.137	SEAL, CR/SHF RR BRG	1627821
32.	0.096	BEARING KIT, CR/SHF (2,4)	18013442
33.	0.646	CRANKSHAFT, ENG	1629093
34.	N.S.	CAP, CR/SHF BRG (PART OF 7)	
35.	8.900	BOLT, HEX (M12X1.75X90)	
36.	1.639	SHAFT, O/PUMP DRIVE	1619035
37.	1.724	SEAL, O/PUMP TO CR/CASE (O RING)(4.107)	1647005
38.	8.977	SCREW, HWH TAP M6X1X13 PC(AR)	11504474
39.	1.516	INDICATOR, ENG OIL	1640021
40.	1.516	TUBE, OIL LVL INDICATOR	1618780
41.	2.042	SHIM, START MTR (2.00 MM)	10008053
42.	2.041	MOTOR, START (CPS)(*4)	1109531
43.	2.042	BOLT, START MTR (M10X1.5X190)	1620786
44.	2.042	BOLT, START MTR (M10X1.5X69)	1620785
45.	8.921	NUT, STAMPED/DF/W-SEALER #10-24 ZC(AR)	9426926
46.	N.S.	BRACKET, START MTR(*3)	
47.	8.900	BOLT, HEX M8X1.25X20 W/CON SPR WA 9.8 PC(AR)	11502676
48.	8.900	BOLT, HFH, M8X1.25X20, 10.9, POR, FULL THD, 17.6 OD(AR)	11509511
49.	N.S.	PICKUP, O/PUMP (PART OF 56)	
50.	1.428	STUD, OIL PAN TO CR/CASE (M8X1.25X30)(2)	464206
51.	1.426	PAN, OIL (INCL 52,53)	1622872
52.	1.456	GASKET, DRN SCR (PART OF 51)(*3)	14090908
53.	1.453	PLUG, OIL PAN DRN (M12X1.75X26.5)(PART OF 51)	10017615
54.	8.915	NUT, HEX (M8X1.25)(AR)	
55.	N.S.	PICKUP, O/PUMP (PART OF 56)	
56.	1.652	PUMP, OIL	3517753
57.	1.609	SPRING, OIL PRESS REG	1607565
58.	1.639	GEAR, O/PUMP	1619036
59.	1.609	VALVE, OIL PRESS REG	1622981
60.	1.723	COVER, O/PUMP	161658
61.	1.724	SEAL, O/PUMP TO CR/CASE (O RING)(4.107)	16470
62.	0.056	STUD, BRG CAP (PART OF 7)	1615
63.	0.738	KEY, CM/SHF DRIVE SPKT	16
64.	0.623	BOLT, CONN ROD	1
65.	N.S.	PIN, FRT CVR	
66.	0.648	SLINGER, CR/SHF OIL	
67.	N.S.	NUT, CLINCH (PART OF 92)	
68.	0.736	SPROCKET, CM/SHF DRIVEN	
69.	0.736	SPROCKET, CM/SHF DRIVE	